

Rev.	Date	Notes
1	02-01-08	Initial Release
A	08-04-09	SIZE TABLE UPDATED

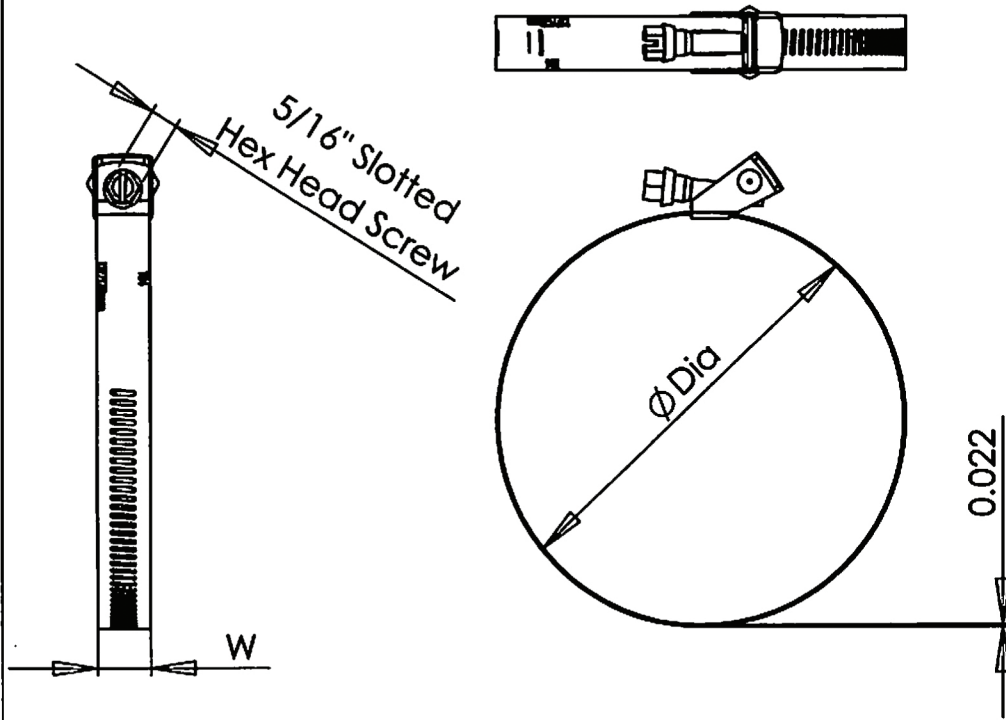

PART NO	MIN DIA	MAX DIA	W
17159	1-3/4"	12-1/4"	1/2"
17160	1-3/4"	16-1/4"	1/2"
17220	1-3/4"	20"	1/2"

- Notes:
1. RoHS Compliant - No Hexavalent Chromium - Cr(VI)
 2. Material: Band and Housing - 200 Series Stainless Steel
Screw - Zinc Plated

	NAME	DATE
DRAWN	J Li	2/5/08
UNLESS OTHERWISE SPECIFIED:		
DIMENSIONS ARE IN INCHES		
[] DENOTES MILLIMETER		
TOLERANCES x.xx ± 0.02 (0.51)		
x.xxx ± 0.005 (0.13)		
MATERIAL		
See Notes		
FINISH		
Semi-Polished		
DO NOT SCALE DRAWING		

TITLE:
Quick Release Clamps

SIZE	DWG. NO.	REV
A	QR Hose Clamps Rev A	A
SCALE: 1:2		SHEET 1 OF 1